

## Locker Installation Instructions

Installation Hardware Supplied by Others.

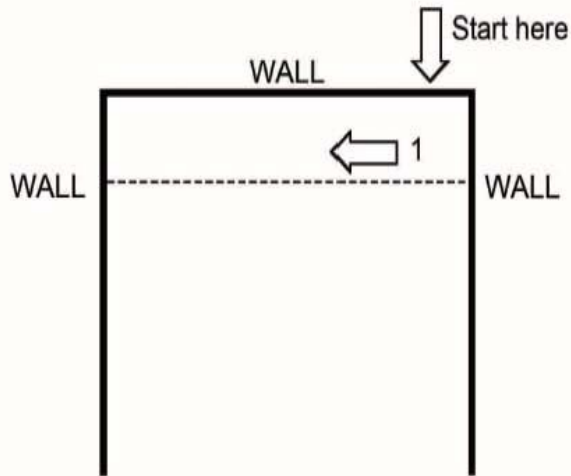

### WALL TO WALL STRAIGHT RUN

- A. Measure locker area between walls. Determine that correct # of lockers will fit.
- B. Start install with the lockers on the right.
- C. If space remaining after lockers installed, use fillers to fill space. Install the fillers to left of lockers (if applicable).
- D. Install top fillers last. Install a support on the wall and rest Top Filler on support and top of locker.
- E. Tighten all nuts and bolts.
- F. Adjust doors.

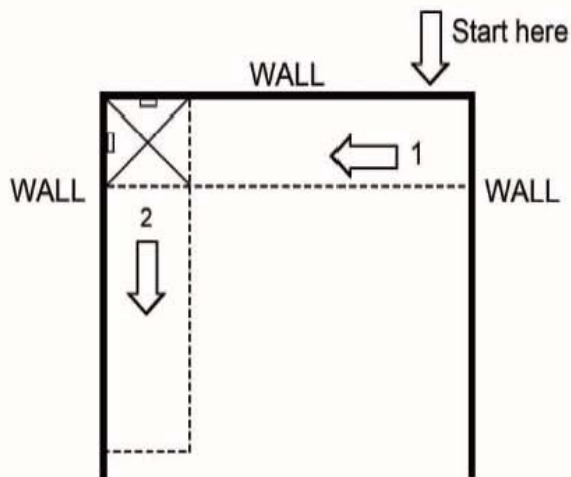

### L SHAPE OPEN END

- A. Measure locker area.
- B. Start with the lockers from back wall right side (if layout is the reverse from shown, start from the left side).
- C. Install fillers to left of lockers (if applicable).
- D. Install some type of blocking on both walls in the corner for top corner fillers to rest on.
- E. Install side wall lockers.
- F. Install top fillers last.
- G. Tighten all nuts and bolts.
- H. Adjust doors.

Lockers MFG: The Locker Manufacturer  
P.O. Box 383258 • Germantown, TN 38183  
Phone: (901) 207-6573 • Email: [sales@lockersmfg.com](mailto:sales@lockersmfg.com)  
[www.lockersmfg.com](http://www.lockersmfg.com)



**PRICE POINT STORAGE PRODUCTS**

**Locker Installation Instructions**  
(Continued)

Installation Hardware Supplied by Others

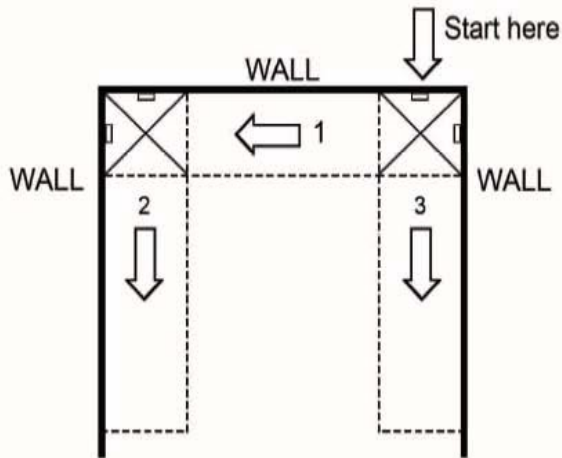

**U SHAPE**

- A. Measure locker area.
- B. Start install of lockers on back wall.
- C. Center back wall lockers.
- D. Install some type of blocking on both walls in the corner for top corner fillers to rest on.
- E. Install fillers.
- F. Install Top Fillers last.
- G. Tighten all nuts and bolts.
- H. Adjust doors.

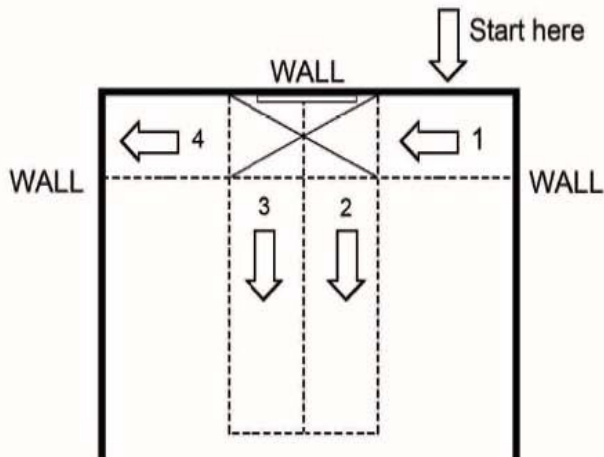

**AREA WITH ISLANDS**

- A. Measure locker area.
- B. Start install lockers on back wall right side.
- C. Install fillers to left of lockers (if applicable).
- D. Install some type of blocking on both walls in the corner for top corner fillers to rest on.
- E. Install fillers.
- F. Install island lockers. Alternate sides, bolt back to back.
- G. Install Top Fillers last.
- H. Tighten all nuts and bolts.
- I. Adjust doors.

\* Note: Fillers to fill open spaces next to lockers can be purchased separately through your local dealer.

**LOCKERS MFG RECOMMENDS THAT ALL LOCKERS SHALL BE ANCHORED TO THE WALL AND/OR FLOOR SECURELY WITH APPROPRIATE FASTENERS.**

Lockers MFG: The Locker Manufacturer  
 P.O. Box 383258 • Germantown, TN 38183  
 Phone: (901) 454-3714 • Email: sales@lockersmfg.com  
[www.lockersmfg.com](http://www.lockersmfg.com)